

# Enabling Location Services Guide

- [Android \(10\)](#)
- [iOS \(14.2\)](#)
- [macOS](#)
- [Windows 10](#)

# Android (10)

## Enabling Location Services on Android

There are two different places that should be checked when enabling location on an Android device

1. System settings on the device itself
2. Settings within the app itself

### System Settings:

- First, navigate to **Settings**

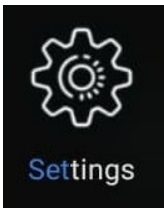

- Scroll down , select **Location**

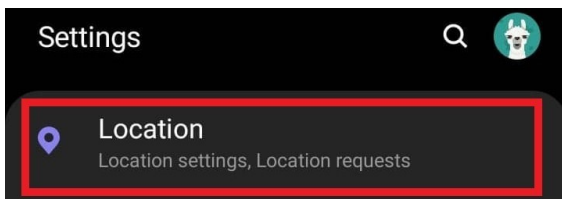

- Verify that Location is set to **On** and then select **App Permissions**

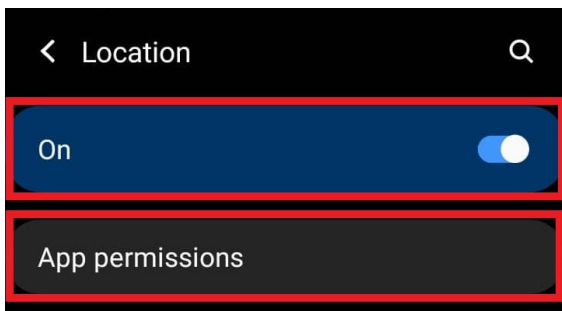

- From here, select the browser you wish to use for logging eTime

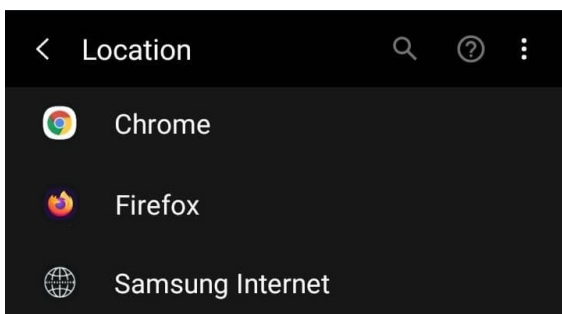

- Verify that Allow only while using the app is selected

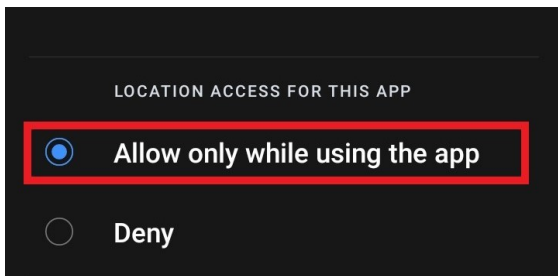

## Google Chrome:

- At the top right corner, select the 3 dots to open the Chrome menu and select **Settings**

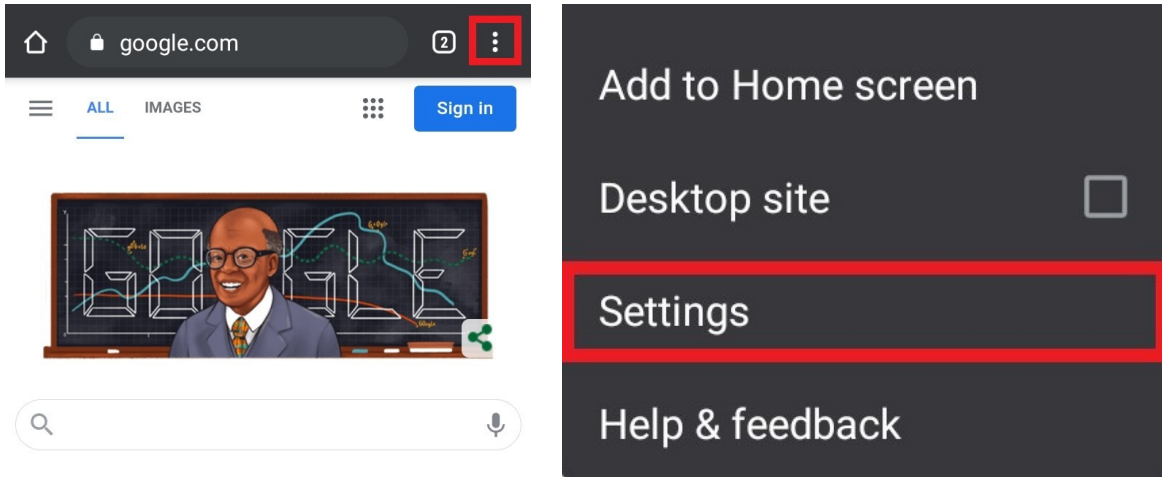

- From the settings menu, scroll down and select **Site Settings** and then select **Location**

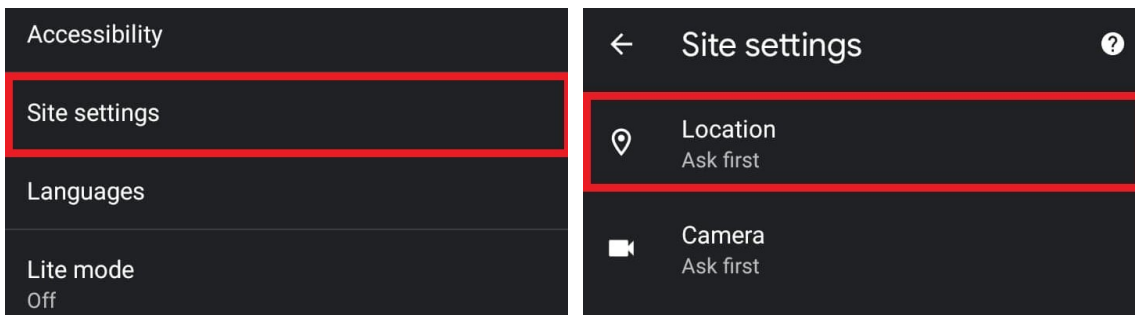

- Verify that the Location slider is on

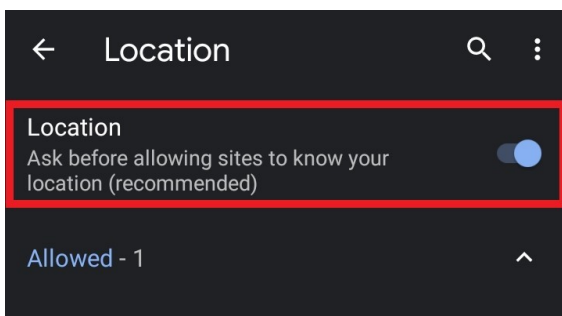

## Firefox:

- At the bottom right corner, select the 3 dots to open the Firefox menu and select **Settings**

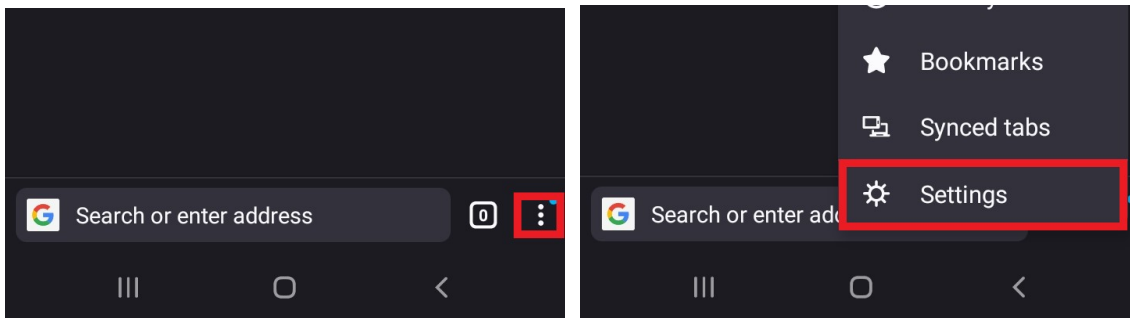

- Select **Site Permissions** and then select **Location**

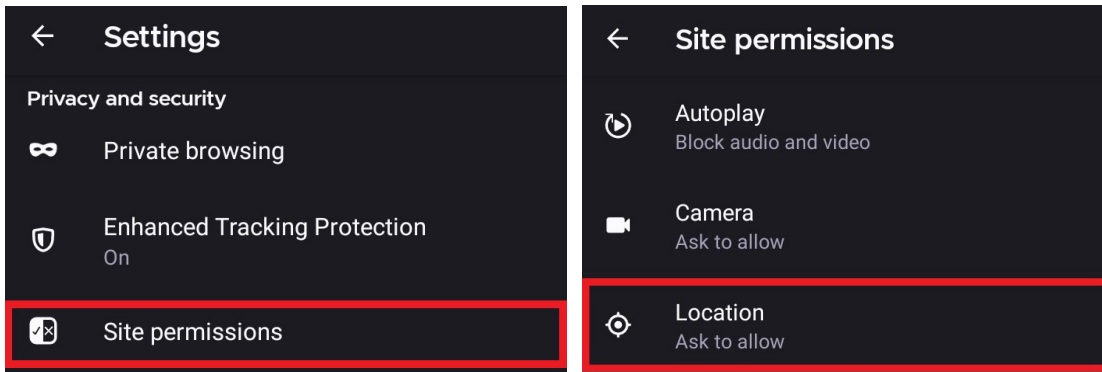

- Verify that **Ask to allow** is selected

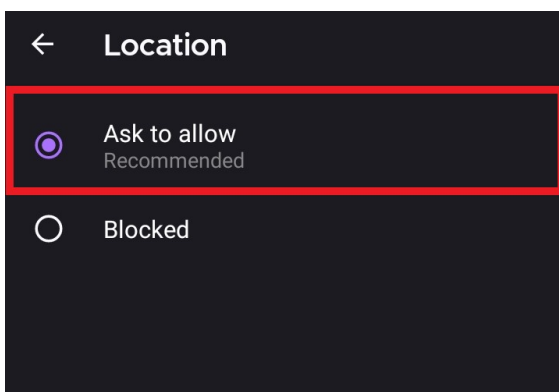

## Samsung Internet:

- See the section above labeled **System** for instructions on enabling location services for the default Samsung browser.

# iOS (14.2)

## Google Chrome:

- First, navigate to **Settings**

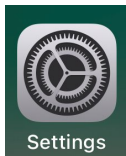

- Scroll down to **Privacy** and select **Location Services**

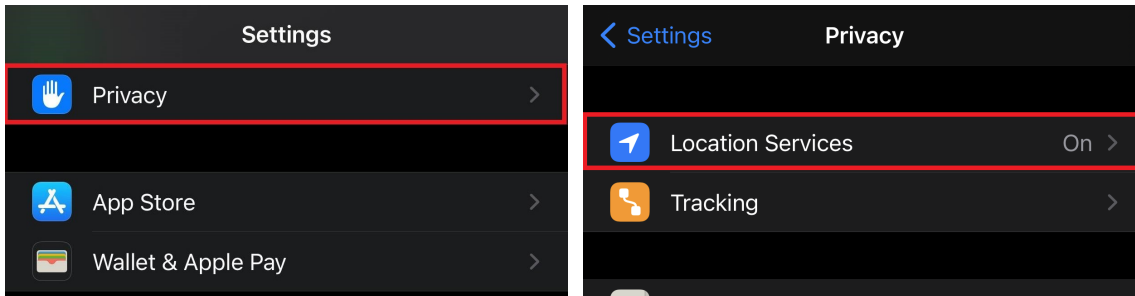

- Select **Location** to turn on location services, then Scroll down and select **Chrome** from the list of installed applications

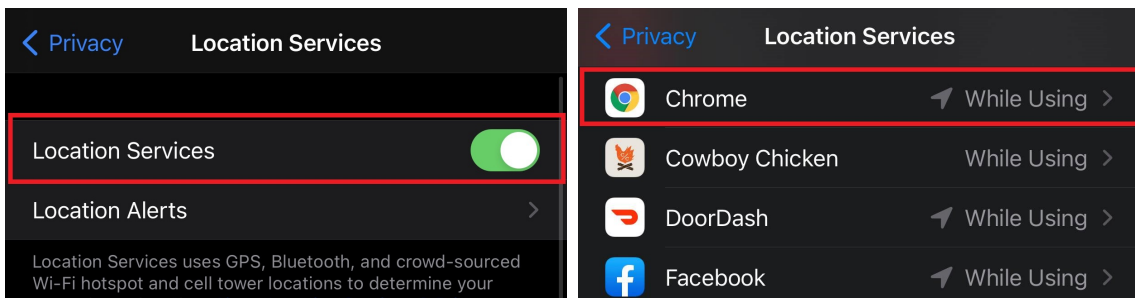

- From the Chrome specific Location settings, select **While Using the App** and **Precise Location** to allow Chrome to use your device location.

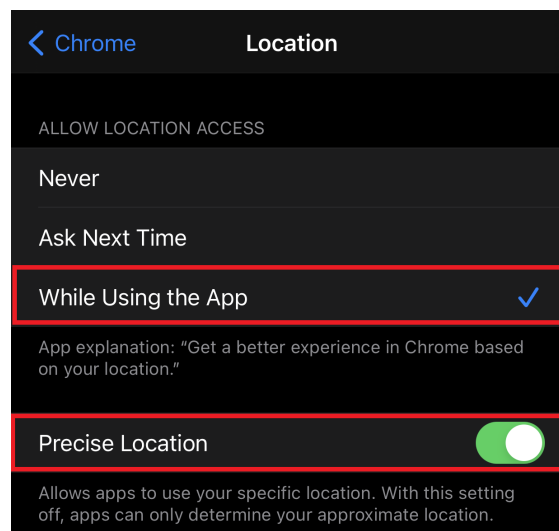

## Firefox:

- First, navigate to **Settings**



- Scroll down to **Privacy** and select **Location Services**

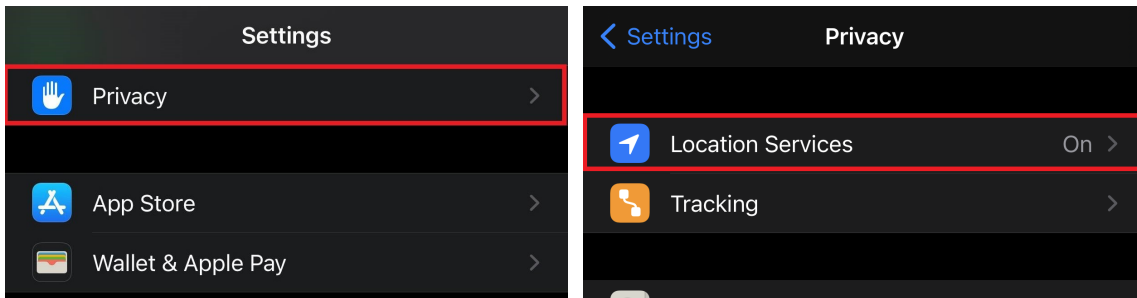

- Select **Location** to turn on location services, then Scroll down and select **Firefox** from the list of installed applications

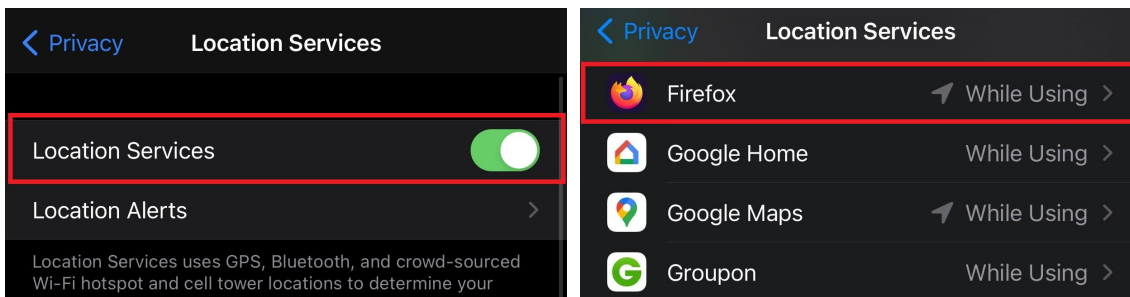

- From the Firefox specific Location settings, select **While Using the App** and **Precise Location** to allow Firefox to use your device location.

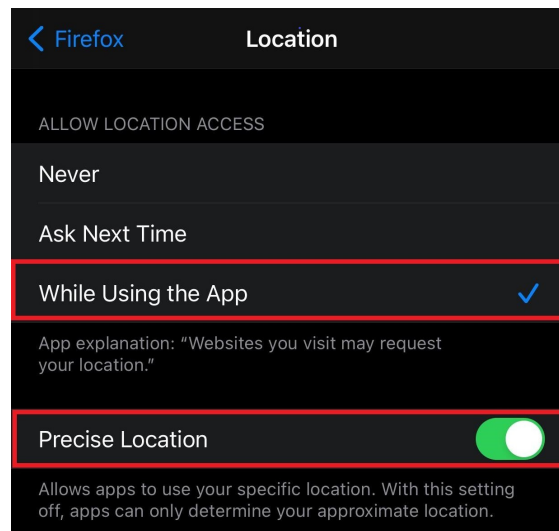

## Safari:

- First, navigate to **Settings**



- Scroll down to **Privacy** and select **Location Services**

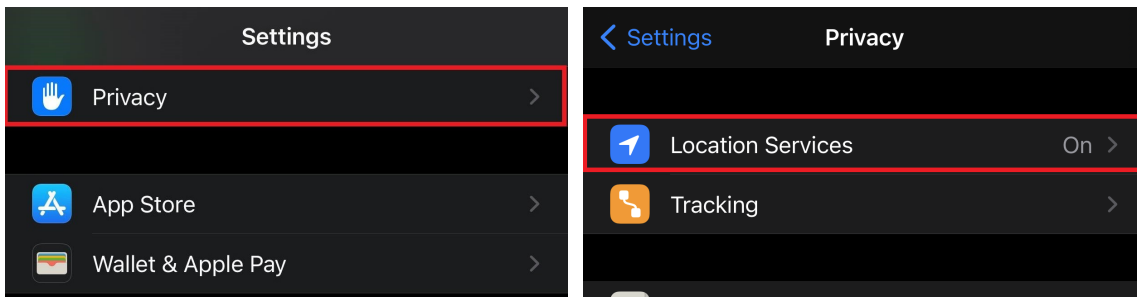

- Select **Location** to turn on location services, then Scroll down and select **Safari** from the list of installed applications

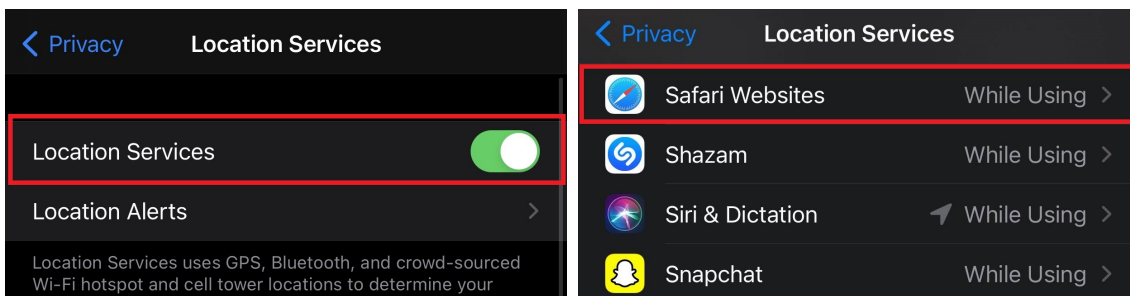

- From the Safari specific Location settings, select **While Using the App** and **Precise Location** to allow Safari to use your device location.

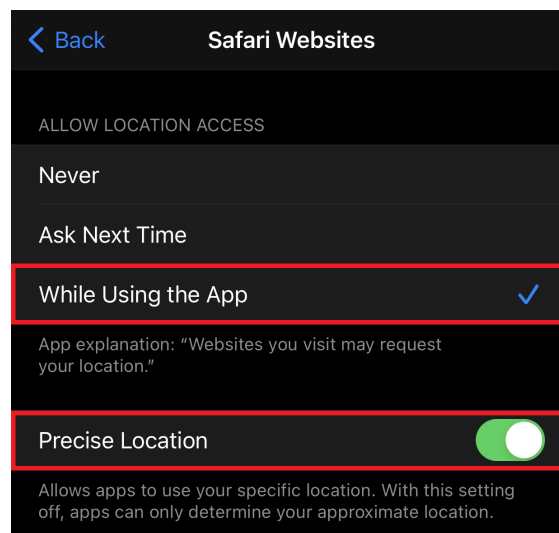

# macOS

- First, navigate to the Apple menu in the top left corner and select

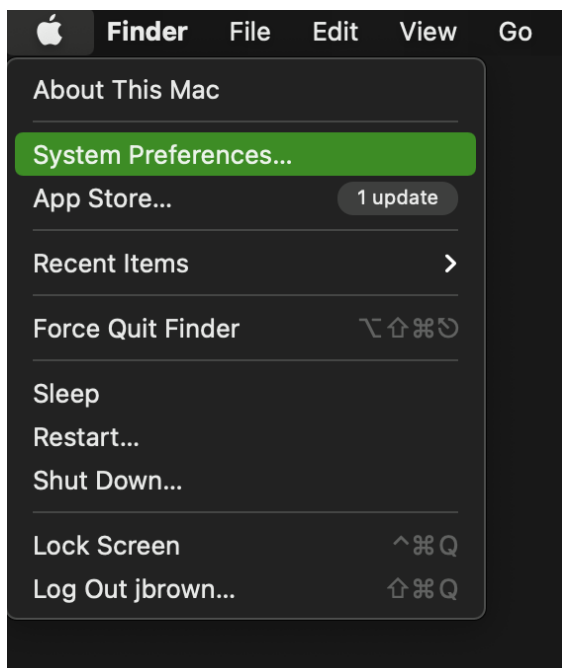

- Next, select **Security & Privacy** and verify that Location Services is enabled. Also be sure to verify that the web browser you are using is given permission.

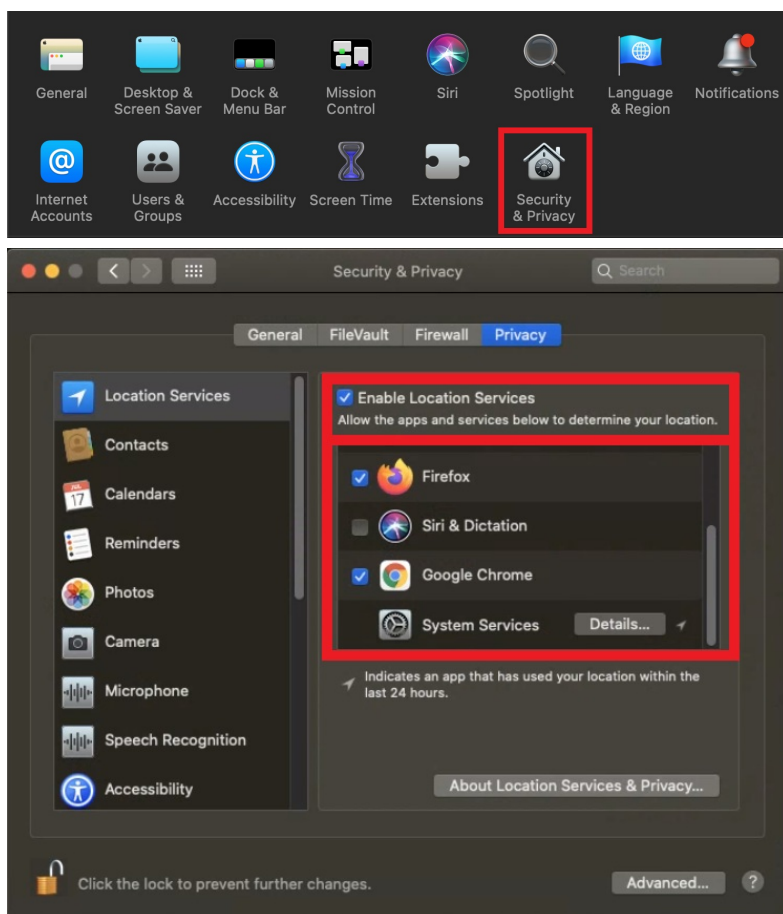



# Windows 10

## System:

- From the Windows desktop, go to: **Start** and select the **Settings** from the lower-left panel menu.

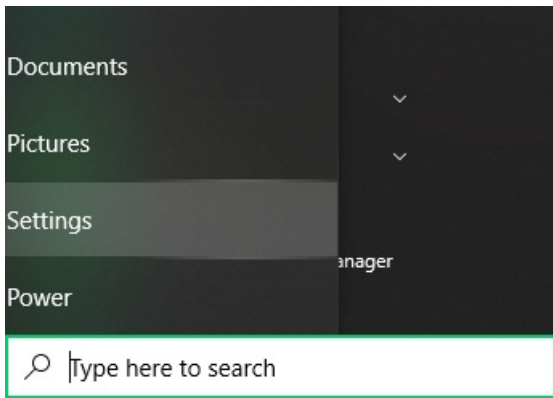

- From the Settings menu, select **Privacy** and then select **Location** from the privacy menu

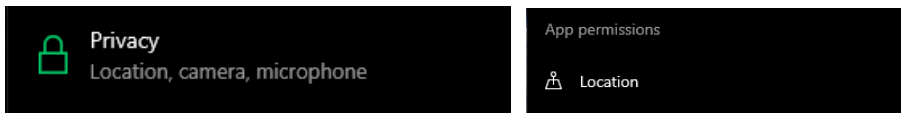

- To set the location on or off, select **Change** located under 'Location for this device is on/off', then select the switch to turn on or off.

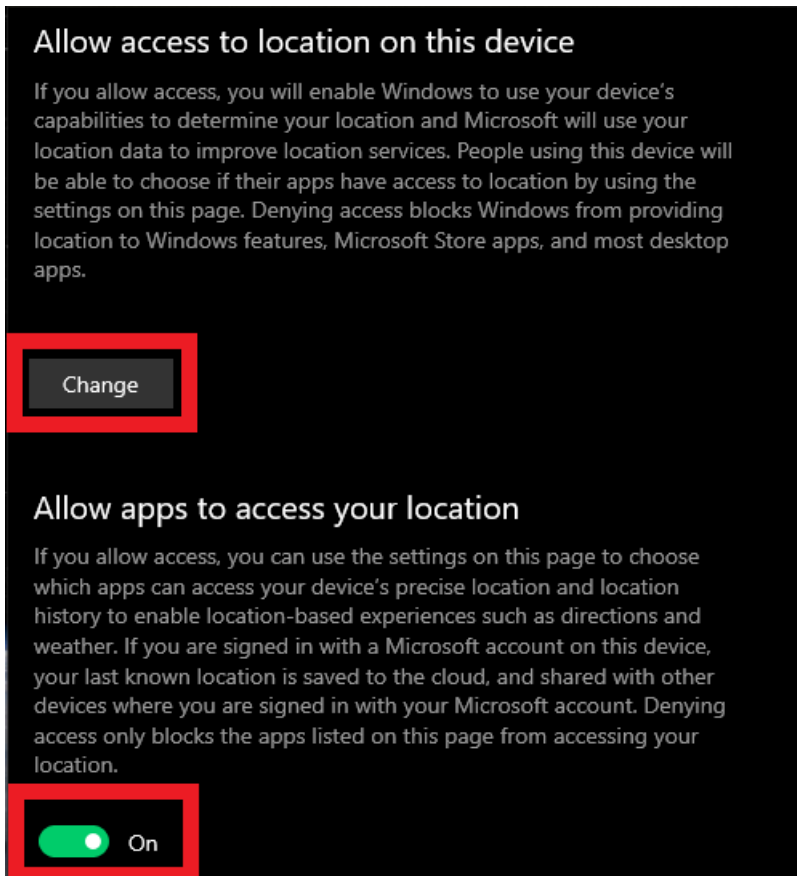

- If Location is turned on, select which apps can use your location by selecting the appropriate on/off switches (to the right of the app).

